

# K11 CHUCK MANUAL

Chuck is a kind of fixture. This product is mainly used to hold all kinds of machining parts in lathe, milling machine, drilling machine, flat grinding and machining center. It is the most suitable mechanical parts for small batch and batch production and processing. Make the connecting sleeve (applicable when it is installed on the lathe, not required in other occasions) and process the inner hole of the connecting sleeve according to the size of the tail end of the spindle on the lathe.

## 三爪自定心卡盘尺寸参数表

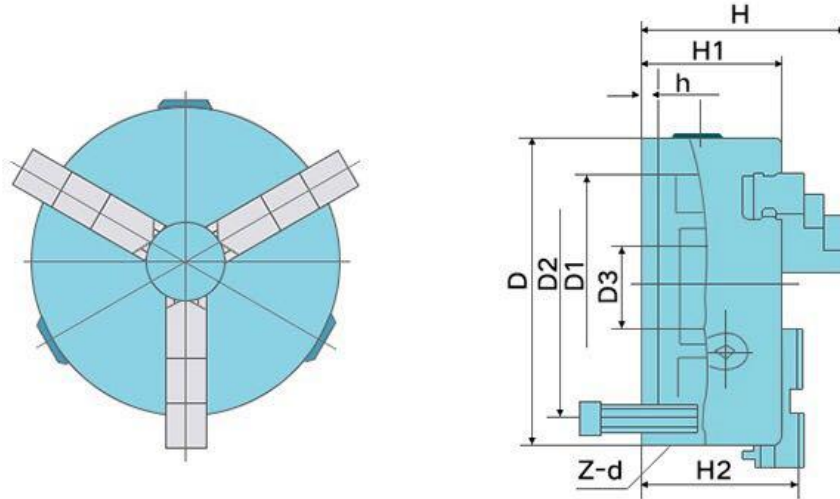

规格D(mm)	D1(mm)	D2(mm)	D3(mm)	H (mm)	H1(mm)	h(mm)	Z-d
80 (3")	55	66	16	66	50	3.5	3-M6
100 (4")	72	84	22	75	55	3.5	3-M8
125 (5")	95	108	30	84	58	4	3-M8
130 (5")	100	115	30	86	60.5	3.5	3-M8
160 (6")	130	142	45	95	65	5	3-M8
200 (8")	165	180	65	113	75	5	3-M10
250 (10")	206	226	80	124	80	5	3-M12
320 (13")	270	290	100	148.5	95	11	3-M16
320C (13")	270	290	100	154.5	95	11	3-M16
400 (16")	340	368	145	155	101.5	6	6-M16
500 (20")	440	465	210	174	115.4	6	6-M16
630 (20")	560	595	280	204	135	7	6-M16

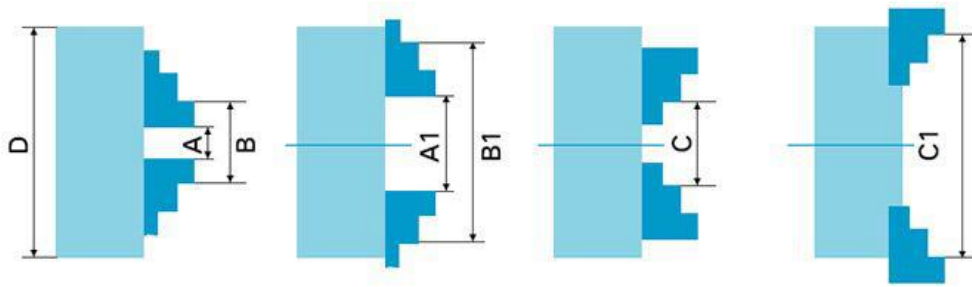

### 夹持范围

规格D size	最大输入扭矩N.m Max.input torque	极限转速r/min Max.speed	最大静态夹紧力KN max.static gripping dia	夹持范围 Clamping Range		
				正爪 internal jaws		反爪 External
				夹紧范围 A-A1	撑紧范围 B-B1	夹紧范 C-C1
80(3")	40	4800	10	2-22	25-70	22-63
100(4")	60	4200	10	2-30	30-90	30-80
125(5")	100	3800	17	2.5-40	38-125	38-110
130(5")	100	3800	17	3-40	40-130	40-120
160(6")	160	3600	24	3-55	50-160	55-145
200(8")	250	3000	31	4-85	65-200	65-200
250(10")	320	2400	37	6-110	80-250	90-250
315(12")	400	1800	46	10-140	95-315	100-315
320(13")	400	1800	46	11.5-145	95-320	110-320
325(13")	400	1800	46	11.5-165	95-350	110-340
400(16")	500	1200	55	15-210	120-400	120-400
500(20")	630	850	65	25-280	150-500	150-500
630(25")	800	600	72	50-350	170-630	170-630